

The Smarter Home

210  
PACIFIC

RESIDENCE

4W

FLOOR: 4

INTERIOR: 1,563 sf

EXTERIOR: 165 sf

-  3 BEDROOMS
-  2 BATHROOMS
-  1 CABANA

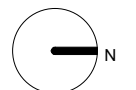
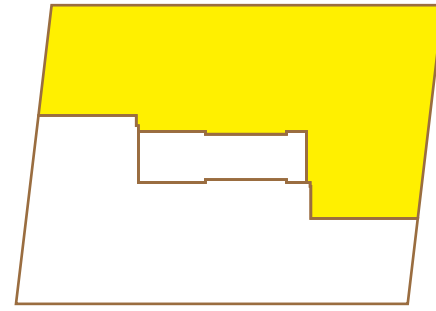





# The future of the city of Brooklyn begins here. 35 years ahead of schedule.

Nestled in the charming and sophisticated neighborhood of Boerum Hill, Brooklyn, this collection of handsome, well-appointed and environmentally intelligent residences delivers a quality of living of the highest order.

Designed, developed and built by NAVA, 210 Pacific is comprised of 8 uniquely detailed and constructed three and four bedroom residences located in one of Brooklyn's most desirable neighborhoods.

## RESIDENCE FEATURES & SPECIFICATIONS

### Exterior

- Custom designed facade made of brass tiles
- Windows fabricated in Germany with triple glazing for sound insulation and energy efficiency
- Custom window shadow boxes at all windows
- Passive House technology employed throughout the building for superior energy efficiency

### Lobby

- Stiehle Intercom with iDor mobile remote monitoring and access control
- Custom fabricated glazed tile panel walls
- Custom Flavor Paper wallpaper

### Building Amenities

- Parking garage with deeded spaces at ground floor
- Private storage rooms located in cellar
- Residents fitness room in cellar
- Residents lounge at ground floor
- Direct elevator access into all apartments
- Common roof terrace with views of Manhattan, NY Harbor and Brownstone Brooklyn
- Bicycle storage
- Solar hot water system with electrical backup

### Residence Amenities

- 6" wide turned rift white oak plank floors and border
- Triple-glazed, German fabricated high performance windows with tilt and turn operation
- Oversized lift and slide German fabricated high performance doors in select residences
- Concealed and integrated window shade pockets pre-wired for electric shades
- Custom solid core doors with stainless steel hardware
- Central heating and air conditioning system with multiple zones
- Always-on Fresh air ventilation employing high efficiency energy recovery system
- Private roof top cabins for 3<sup>rd</sup> and 4<sup>th</sup> floor apartments
- Private terraces for 2<sup>nd</sup>, 5<sup>th</sup>, 6<sup>th</sup> and 7<sup>th</sup> floor apartments
- Rift-sawn white oak custom cabinetry in select residences

### Kitchens

- Custom fabricated kitchens with rift white oak and Corian cabinets
- Honed statuary marble slab countertops and backsplashes
- Undercounter LED lighting
- In-Sinkerator garbage disposals
- Blanco stainless steel sinks and faucets
- Kitchen appliance packages include:
  - Sub Zero integrated refrigerators and freezers
  - Miele fully integrated dishwashers
  - Miele slide out vent hoods
  - Miele frameless induction cooktops
  - Miele stainless steel wall ovens
  - Miele microwave/speed ovens

### Master Bathrooms

- Statuary marble slab countertops, backsplash and walls
- Custom back painted glass walls
- Round glass penny floor tile by Ann Sacks
- Glass enclosed shower rooms featuring statuary marble slabs
- Custom statuary marble vanity tops with integrated custom sinks
- Rift-sawn white oak vanities
- Free standing Victoria + Albert tubs in select master baths
- Duravit Starck one piece toilet
- Zucchetti plumbing fixtures
- NuHeat in-floor heating with independent thermostat

### Secondary Bathrooms

- 4" x 48" porcelain tiled walls and floors from Stone Source
- Custom colored back painted glass walls
- Custom corian vanities
- Opaque white glass countertops and backsplashes
- Duravit undermount sinks
- Duravit Starck one piece toilets
- Duravit bathtubs
- LaCava plumbing fixtures

### Powder Rooms

- Blue de Saviole marble slab floors and walls
- Blue de Saviole custom carved sinks
- Custom colored back painted glass walls
- Heath ceramics feature wall
- Duravit Starck one piece toilets
- Zucchetti plumbing fixtures

The Smarter Home  
**210**  
PACIFIC

RESIDENCE  
**4W**